



Extender

for Reduced Size MultiMediaCard(RS-MMC™)

AD-MK Handling Instructions

Thank you very much for choosing our AD-MK, Extender for Reduced Size MultiMediaCard(RS-MMC™). By attaching this extender to RS-MMC™, you can use RS-MMC™ as regular MultiMediaCard for any devices applicable to MMC. Please read this handling instruction carefully before you use the Extender.

1. Attention on safe

 WARNING	This sign implicates that there is a certain risk of getting serious injuries or death in case the instruction with this sign above is not followed.
 CAUTION	This sign implicates that there is a certain risk of serious injuries and a risk of materials damages in case the instruction with this sign is not followed.

WARNING

- Please follow this instruction as well as any warnings and cautions described in those instructions of personal computer and other related equipment on which the Extender is to be used.
- Please place this Extender away from infant. In case infant swallows the Extender, please consult with a doctor immediately.
- Please do not insert the Extender into MultiMediaCard slot separately. It might cause breakdown for electrical devices due to electrical shock or short. It might even cause fire.
- Insulating treatment is done on its body. Please stop using the item when the treatment of the insulation is somehow damaged. It might cause breakdown for electrical devices due to electrical shock or short. It might even cause fire.

CAUTION

- Please do not either disassemble or reconstruct the Extender.
- Please do not place any stickers or labels on the product. It might cause breakdown.
- Please do not give any strong shock, bend the body, drop, or wet the Extender.
- The Extender has the certain direction for attaching to RS-MMC™. Please attach the Extender into RS-MMC™ as it is instructed below.
- Please keep the Extender with free of dust or foreign substance.
- Please do not rub the body of the Extender very strongly or you may damage the insulate surface. It might cause breakdown of the Extender and other devices.

2. Attachment instruction

The name of each section

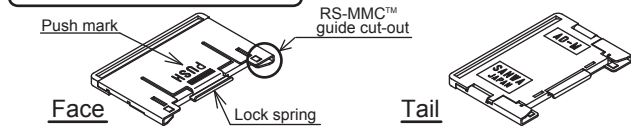

Direction for attachment

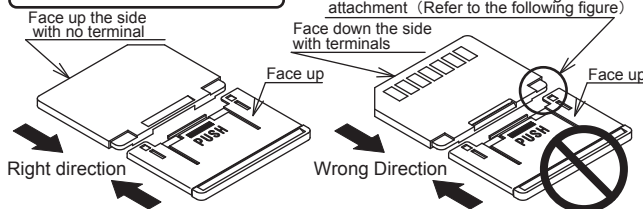

Prevention mechanism for wrong direction attachment

See section A; The size of the guide cut-out differs among the face and tail side. (Right and left becomes the same.)



3. Attachment method

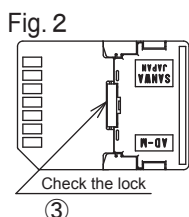
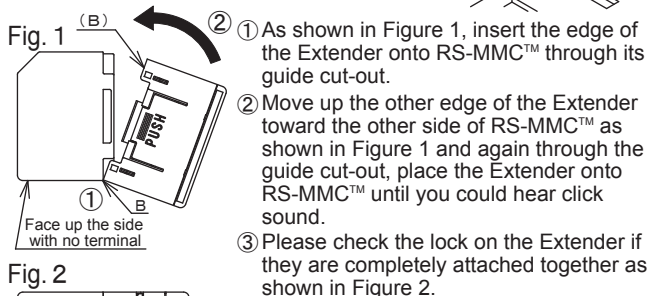

- ① As shown in Figure 1, insert the edge of the Extender onto RS-MMC™ through its guide cut-out.
 - ② Move up the other edge of the Extender toward the other side of RS-MMC™ as shown in Figure 1 and again through the guide cut-out, place the Extender onto RS-MMC™ until you could hear click sound.
 - ③ Please check the lock on the Extender if they are completely attached together as shown in Figure 2.
- ※ The Extender has the prevention mechanism to avoid wrong direction attachment with RS-MMC™. If they are forced to be attached in wrong direction, it might cause serious damages to both RS-MMC™ and the Extender.
- ※ Please do not touch the terminal section of RS-MMC™ when attached to the Extender.

4. Removal method

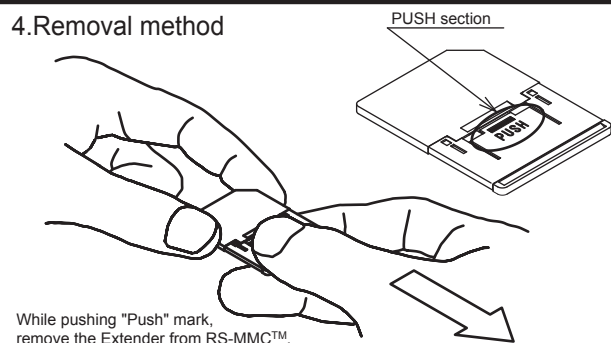

While pushing "Push" mark, remove the Extender from RS-MMC™.

- While pushing "Push" mark on the Extender to release the lock, remove the Extender from RS-MMC™ horizontally. (the direction of an arrow).
- ※ Please do not touch the terminal section of RS-MMC™ when removing the Extender.
- ※ Please remove both the Extender and RS-MMC™ together from MultiMediaCard slot of terminal machines, or only RS-MMC™ will be left in the MultiMediaCard slot.

5. Caution while operation

- Please treat the Extender gently. Please apply extra caution while inserting or extracting the Extender with RS-MMC™ from card slot.

6. Support

- Any inquiry of this Extender, please contact to "Sanwa Electronics USA Corporation".
- For information of RS-MMC™, please contact to the maker.



Sanwa Electronics USA Corporation
4020 McEwen Drive, suite 118 Dallas, TX 75244 USA
TEL:1-972-503-3031 FAX:1-972-503-3032
E-mail:mkt@snwd.co.jp



Sanwa Denki Kogyo Taiwan Office
13F-5 No.77 Sec.1 Shintai 5th Road Shinjr City, Taipei Taiwan
TEL:886-2-8698-2131 FAX:886-2-8698-2132
E-mail:mkt@snwd.co.jp

About the result of employment of a product, since responsibility cannot be taken, please understand the contents of this book beforehand. Please understand beforehand that responsibility cannot be taken about the result of employment of this product in our company. The license of RS-MMC™ is carried out to MMCA (MultiMediaCard Association).